



SPORT 43 OPEN / HARDTOP.

Productbook.

November 2010



SPORT 43. Top UPS's.

- **Design/Concept:**

- Sportiness and lengths thanks to extraordinary exterior design
- The Hardtop is fully integrated into the overall concept with an electrical soft-top

- **Deck**

- Forward-facing co-pilot seating bench for two people with additional sun lounger for third
- Symmetrical 'Big Boat' - Rear view with wide/comfortable side decks
- Large sunbathing area at the rear whilst sitting at the cockpit table possible
- Large bathing platform (hydraulically lowerable as option)

- **Interior**

- 3 Cabin-version available in a 43-foot yacht (separate beds in the aft cabins – but can be easily converted into a large double bed)
- Larger owner's wellness bath with detached shower or rather a separate shower (depending on cabin version)
- Shower for your guests with full standing height (in two-cabin version)

- **Systems**

- Available with Z-drive as well as IPS
- All cabins are optional available with air-conditioning

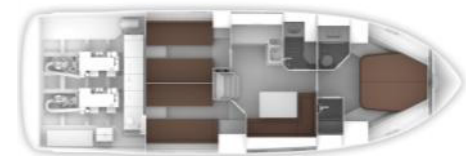

SPORT 43. Facts.

		Sport 43 Open	Sport 43 Hardtop
Technische Daten	technical data		
CE-Kategorie		B	B
Gesamtlänge (ohne BPF)	Length overall (without BPF)	13,83 m	13,83 m
Rumpflänge	Length hull	13,22 m	13,22 m
Gesamtbreite	Beam overall	4,41 m	4,41 m
Höhe über Wasser, ca.	Height above waterline, approx.	3,35 m	3,33 m
Gesamthöhe	Height overall, approx.	4,08 m	4,06 m
Tiefgang, Antrieb oben (ca.)	Tiefgang	0,75 m	0,75 m
Tiefgang, Antrieb unten (ca.)	Tiefgang	1,10 m	1,10 m
Leergewicht, ab ca.	Unladen weight from, approx.	11.750 kg	11.950 kg
Kraftstofftank	Fuel tank, approx.	1.500 l	1.500 l
Wassertank	Water tank, approx.	410 l	410 l
Fäkalientank	Waste water tank, approx.	140 l	140 l
Passagiere	Persons, max. CE B	12	12
Kabinen	Cabins	2/3	2/3
Kojen	Berths	4/6	4/6
Stehhöhe in Kabine, ca.	Height in cabin, approx.	2,10 m	2,10 m
Länge Wasserlinie	Waterline Length L_{WL}	11,22 m	11,22 m
Breite Wasserlinie	Waterline Beam, B_{WL}	3,93 m	3,93 m
Kimmbreite	Chine Beam, B_C		
	Canoe Body Depth, T_C		
Kimmwinkel	Deadrise Angle, β		
Motorisierung	Z-Antrieb - stern drive		
	2 x Volvo-Penta D6 - 370 EVC 261 kW		
Motorisierung	IPS		
	2 x IPS-500 D6-370 259 kW		
	2 x IPS-600 D6-435 307 kW		

All preliminary data are based on CAD !

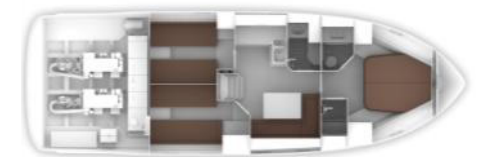

SPORT HT 43.



SPORT 43 OPEN.



SPORT 43 OPEN.

